



**Business Line**  
Sandwichpanelen  
*by Cladding Point*

**DELTA-GS**

PIR hardfoam *(Visible confirmation)*

Sandwich Panels  
Roof & Façade Applications

Technical Information

# DELTA-GS

PIR hardfoam (visible confirmation)

**Business Line**  
Sandwichpanelen  
*by Cladding Point*



## DISCOVER AND EXPERIENCE

DELTA-GS is a visibly attached rigid foam sandwich panel from our Business Line range with a standard working width of 1000mm. The sandwich panel is available in a trapezoidal profile (exterior) and 2 (interior) profiles. Discover the possibilities in Simplicity and Certainty.



For the climate



Corporate Responsibility



Circular construction economy



Building Together

At Cladding Point, we take responsibility, which is why we work things that really matter. By using responsible materials in our sandwich panels, we strive for a Circular Construction Economy.

And how do we work with our suppliers? We make sure that we have a positive impact on everyone we do business with, based on fairness and equality.

We realize it won't be easy, but waiting is not an option. Together we are building a better future.

### Working width

This product is available in a working width of 1000mm as standard.

### Thermal efficiency

DELTA-GS has a hard foam core with PIR technology. This with a density of 40kg/m<sup>3</sup>, completely HCFC-free. The insulation values of the sandwich panels have been calculated in accordance with NEN-EN 10211-1, NTA 8800 and EN 14509 (including fasteners, transition resistors and build quality correction factor).

### Fire class

DELTA-GS complies with the European fire classification B-s1-d0 in accordance with EN 13501-1.

Product conforms to Broof. Classification based on results of tests on the fire hazard of roofs, in accordance with EN 13501-5.

### Air permeability

The air permeability with regard to the seam connection in accordance with EN 12114.

Positive (+)		Negative (-)	
C	0,0046	C	0,0033
n	1,2421	n	1,0658

C = Air flow coefficient  
n = Air flow Exponent

Based on the above assessment, we can conclude that the contribution of the sandwich panels, i.e. the mutual the total air permeability of a building.

In order to meet the requirements, it is particularly important that extra attention is paid to finishing the connection joints with other materials. You can think of window and door frames, penetrations, other façade and day openings, floor and roof connections and the like.

The Building Decree only sets requirements at building level. This is the so-called qv10 value. In other words, the leakage loss through the entire building envelope in dm<sup>3</sup>/s per m<sup>2</sup> of usable area.

There are therefore no specific requirements for the façade panels (individual materials). This product meets the requirements of the Building Decree.

### Water

Water vapor chargeability is impermeable. Water permeability Class A-1200 PA.

### Statics

For a correct determination of the static capabilities of this product, please contact our technical department. We advise you to apply capillaries.

### Management systems

The DELTA-GS sandwich panels are produced under the following management systems; EN ISO 9001 and EN ISO 14001.

### General Certifications

DELTA-GS is manufactured from the highest quality materials and meets the strictest standards and quality controls. This product is CE certified.

### Lengths

Product Length	Possible up to 16.500mm
Length (standard)	2.000mm - 13.500mm
Length* (not standard)	400mm - 2.000mm 13.500mm - 16.500mm

\* Additional costs and transport surcharges may apply. Ask about the possibilities and conditions.

### Tolerances

Joint connection (2mm)	+2mm	-2mm
Length ≤3000mm	+5mm	-5mm
>3000mm	+10mm	-10mm
Working Width	+2mm	-2mm
Thickness (d) ≤100mm	+2mm	-2mm
(d) >100mm	+2%	-2%
Squareness (s)	<0,6%	

Tolerances are compliant EN 14509

### Exterior coatings

Terracoat 27µm is a durable and aesthetically pleasing product and delivers good performance. The UV resistance (RUV3) and increased corrosion protection (RC3) ensure good colour retention.

Granite® HDX (type G) 55µm is a technical, durable and aesthetically pleasing product and delivers very good performance. Excellent UV resistance (RUV4) and increased corrosion protection (RC5) ensure excellent colour retention.

### Standard coatings interior

The base coating is polyester 25µm and suitable for standard indoor environments. This polyester (PE) interior coating can be used on façades, roofs and ceilings, related parts and accessories.

On request, the interior coating can also be made in a suitable coating for the food sector, agricultural sector, wet rooms and an aggressive environment. On request, this product is also available in stainless steel 304/316.

### Total overview of coatings/colours

For the possibilities, see our complete Granite Standard 10 year guarantee warranty on structural and thermal performance. Coating warranty with the possibility of up to 4 years (depend on the type of coating and project specific information). Project specific guarantee possible on request.

### Supplies

Our deliveries from the Business Line are unloaded free of charge and are largely transported by means of road transport and are based on Lean and Green and Euro 6-7.

### Assembly Instructions

Our assembly instructions can be downloaded from our website or available from Cladding Point Technical Services. The 3-D models are included in the Tekla library: [www.tekla.com](http://www.tekla.com)

### Product Name

Product name of our manufacturer Górstal for this product is D 1000 PIR and is therefore mentioned as such on relevant certificates. Ask about the conditions and any additional costs for the above certifications.

### General

When used as a façade; Ask for the conditions.



### Circular construction economy

Cladding Point believes it is important that the Circular Construction Economy is also measurable. That is why we have chosen to draw up an EPD for a large part of our products. An EPD (Environmental Product Declaration) gives the customer insight into how sustainable our sandwich panels are. In the Netherlands, we also use the EPDs to calculate how much environmental damage a building causes in relation to its surroundings. This is done in the environmental performance for buildings calculation, also known as the MPG. The sandwich panels of the PR Business Line are not included in our Circular Construction Economy concept.

The sandwich panels of Business Line ARpanel and Brucha can offer the desired solution to reduce the environmental damage of your building.

What is special is that these products have an EPD with a category 1 card that complies with the regulations from the RVO. This is the highest achievable level. When you apply these in a circular building, you can achieve substantial tax benefits. To advise you on this, you should always contact Cladding Point.

Technical Properties

DELTA-GS						
Thickness (mm)	40/80	60/100	80/120	100/140	120/160	160/200
Total panel weight (kg/m <sup>2</sup> )						
Outer plate thickness 0.5 mm	10,40	11,20	12,00	12,80	13,60	15,40
Inner plate thickness 0.5 mm						
Noise Reduction (Rw (C,Ctr) dB)	-24 (-1;-3)	-24 (-1;-3)	-24 (-1;-3)	-24 (-1;-3)	-24 (-1;-3)	-24 (-1;-3)
Rc-Value (m <sup>2</sup> .K/W), NTA 8800, PIR	1,93	2,93	3,94	4,94	5,94	7,96
Rc-Value (m <sup>2</sup> .K/W), NTA 8800, <b>PIR max.</b>	2,06	3,13	4,19	5,24	6,30	8,41

Cross Section Panel

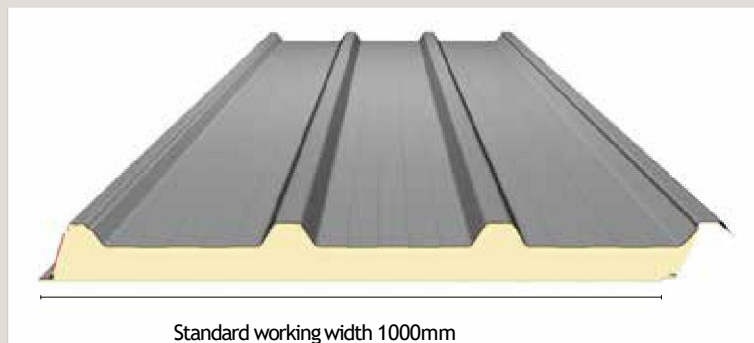

Connection (visible mounting)

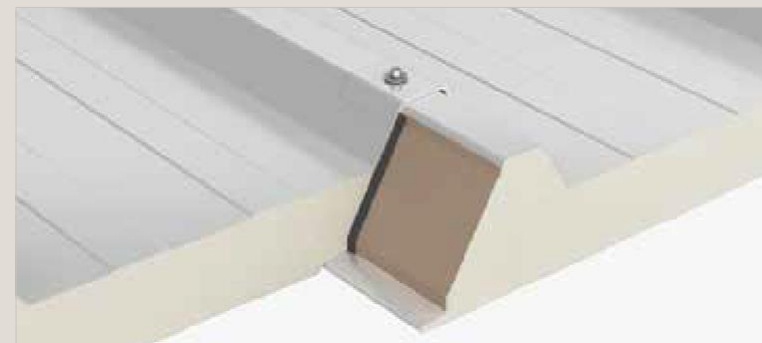

# The Profiles

**DELTA-GS** PIR hardfoam *(visible confirmation)*

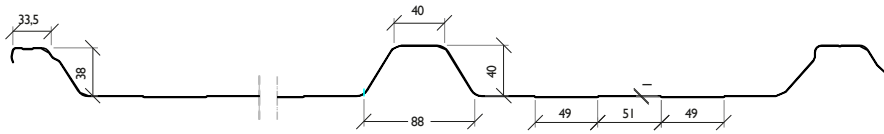

**TRAPEZIUM**



PROFILING	EXTERIOR	INTERIOR
Trapezium	ja	nee
Box	nee	ja
Unprofiled	nee	ja

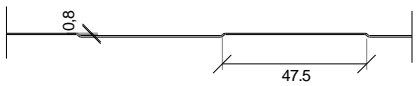

**BOX**



**UNPROFILED**

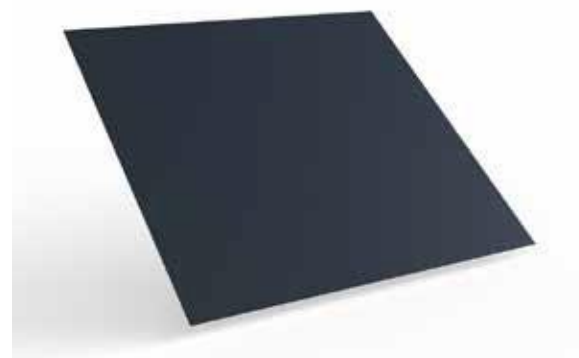

# DELTA-GS PIR hardfoam (visible confirmation)

Standard Cut-back options (50-100-150-200-250-300mm). If a different size is desired, this is on request.

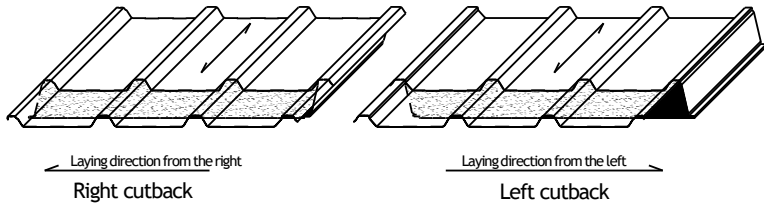

Please note! Clean Cut-back is available on request.



## Cross Section

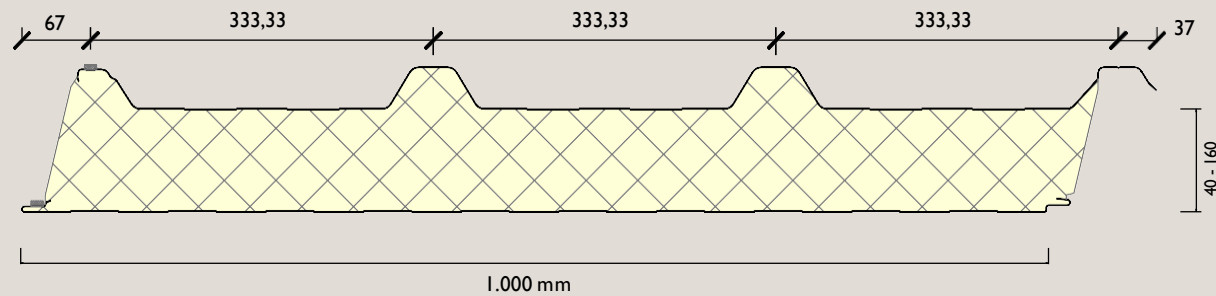

## Confirmation (visible confirmation)

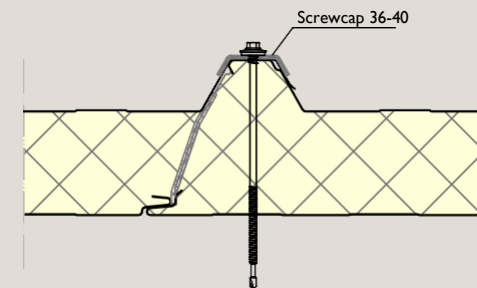

# DELTA-GS PIR hardfoam (visible confirmation)

Ridge detail

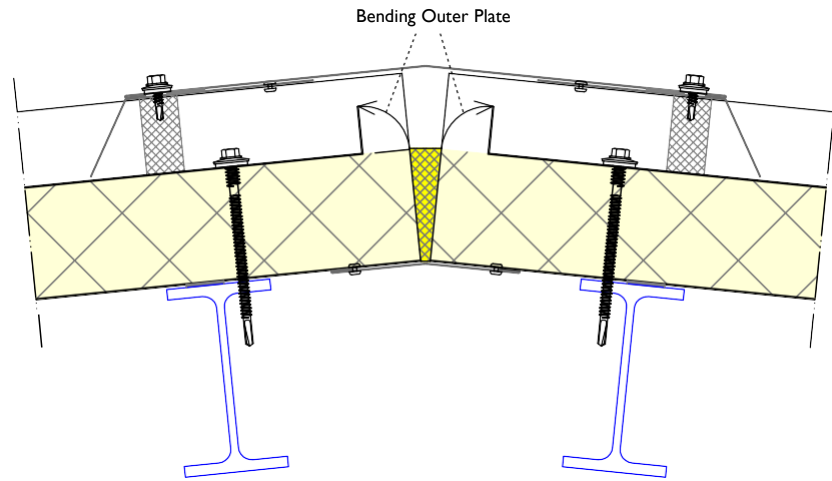

Roof pitch

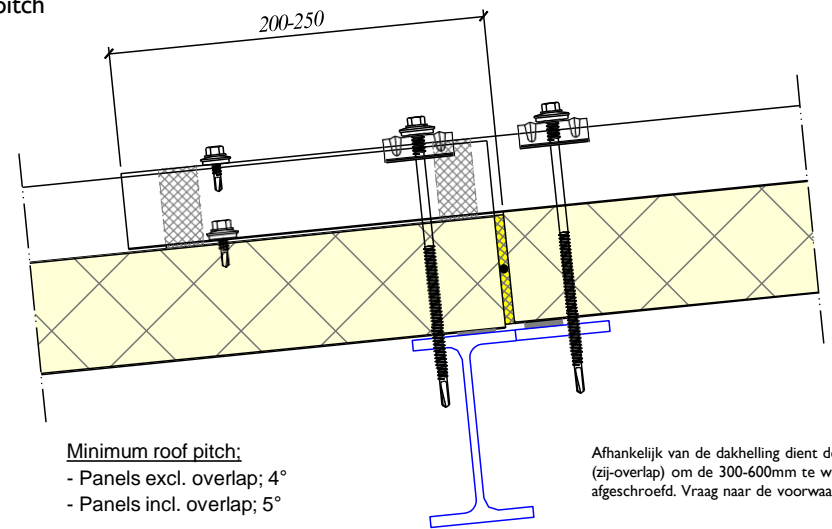

Afhankelijk van de dakhelling dient de buitenzijde (zij-overlap) om de 300-600mm te worden afgeschroefd. Vraag naar de voorwaarden.

Cross Section A-A

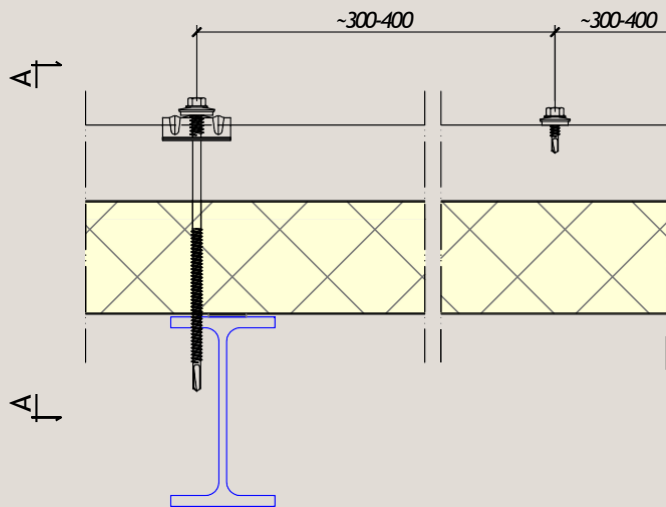

Cross Section A-A

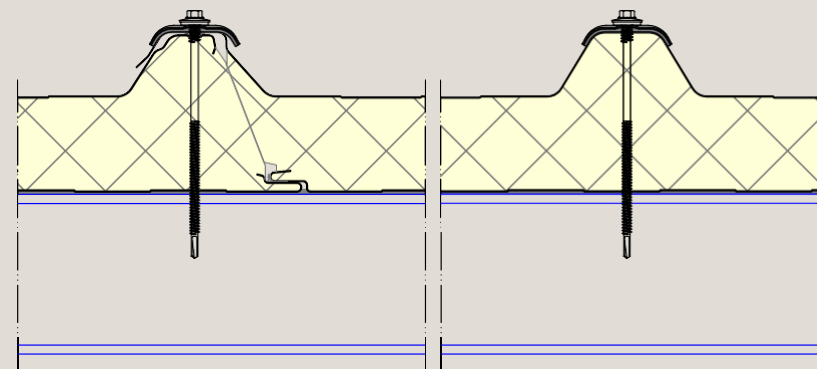







**Want to know more?**

**Cladding Point is continuously improving and testing its products. New test results are added on a regular basis. If the desired specifications with any associated conditions, which are applicable to your project, are not included in the manual, please contact the technical department for the possibilities and/or the latest state of affairs. In many cases, we can offer you a suitable solution.**

**Business Line**  
Sandwichpanelen  
*by Cladding Point*

Platinum Panel Systems  
T: +44 (0) 1744 747 580  
E: [info@platinumpanelsystems.com](mailto:info@platinumpanelsystems.com)